

# Tips & tricks Partition shower wall

For quick and safe handling



# Tips & tricks – Partition shower wall



## Requirement

Partition shower walls are generally made using glass, aerated concrete blocks or drywall construction. However, they are generally not strong enough to support shower doors, radiators, shelves or tray elements. Possible variants here are:

- Wall without door fixings
  - a) tiled on both sides b) only tiled on the shower side
- With door fixings
  - a) tiled on both sides b) only tiled on the shower side
- Attachment of a radiator to the wall

## Solution: wedi building board

- wedi building board 50 mm (2500 x 600 mm)
- wedi building board XL 50 mm (2500 x 900 mm)
- wedi building board XXL 50 mm (2500 x 1200 mm)

### Versions:

- a) Unlimited length of partition shower wall if:
- the building boards are glued as 20 cm wide strips stretching to the ceiling at least every 120 cm.
  - the wall makes an offset of 20 cm at a 90° angle at least every 120 cm.
- b) Limited length of 1.20 m if the building board is only attached to the wall and floor.

### Note:

The wedi building board is waterproof and can be used as a compound seal. The connection with adjacent components (wall / floor) should be implemented in accordance with the specifications (see "Sealing and decoupling" technology brochure).



### Tip:

The final wall height can be shortened during tiling. Calculation of the exact wall height before tiling / installation of the wall is not necessary.

## Work steps



1 Mark the angle and plumb line for positioning of the wedi building board and check full surface bedding of the building board on the floor, trim if necessary.

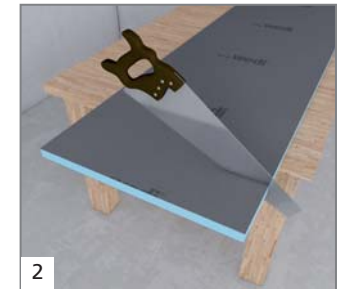

2 Cut the wedi building board to the desired dimensions using a cutter, saw, hand-held circular saw or jigsaw.

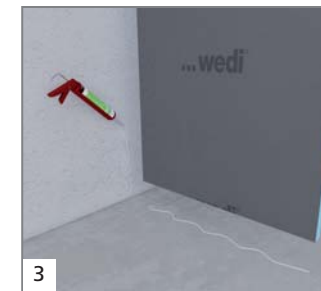

3 Apply wedi 610 to the building board and wall in wavy lines (full bonding) and place the building board in the marked position. Fix in position if necessary.

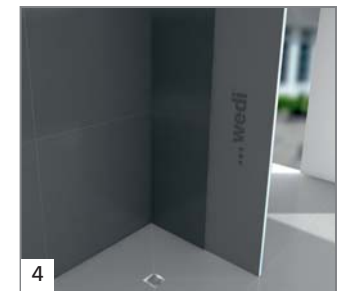

4 Cover the building board with tiles on both sides. The ceramic tiling is required for the strength of the building board. Alternatively, the ceramic tiling can be substituted on one side for a 5 mm reinforcement layer (tile adhesive and reinforcement fabric). Fabric weight 160 g/m<sup>2</sup>.

# Tips & tricks – Partition shower wall

## Comparison: Masonry – wedi building board XXL (Installation example: 120 x 200 cm wall)



### Tools required:

- Spirit level
- Pencil
- Stirrer for mortar and plaster
- Hand saw for stones
- Trowel
- Smoothing trowel / spatula
- Cutter
- Drill for wall anchor



### Tools required:

- Spirit level
- Pencil
- Cutter, jig-saw or portable circular saw
- Cartridge dispenser

Conventional masonry	Quantity	Processing	Drying
Stone Porous concrete 599 x 75 x 249	16 pcs., 18 kg	144 minutes	1 day
Adhesive	3 kg		
Fabric	5 m <sup>2</sup> , 0.5 kg	64 minutes	1 day/mm 3 – 4 days
Reinforcing mortar	30 kg		
Wall anchor Connection to other masonry	5 pcs.	10 minutes	–
Composite seal on the shower side	3 kg	20 minutes	approx. 2 hrs after the 1st coat approx. 4 hrs after the 2nd coat
<b>Total weight:</b>	<b>54.5 kg</b>	<b>238 minutes pure work time</b>	<b>only tileable after 5 days at the earliest</b>

wedi building board XXL	Quantity	Processing	Drying
wedi BA XXL 50 mm 120 x 250 cm	1 pcs., 13.8 kg	30 minutes	1 day
wedi 610 Connection to wall and floor			
<b>Total weight:</b>	<b>14.3 kg</b>	<b>30 minutes pure work time</b>	<b>tileable on the next day</b>

(Drying times according to the manufacturer's instructions / regulations must be observed.)

These versions should be agreed with the appropriate manufacturers without fail. wedi approved the BA 50 for use as partition shower wall.

### Note:

Not considered in the comparison:

- Set-up and cleaning times for the job and the tools (extra time for masonry)
- Transportation of materials

### Advantages:

- Less material to transport / carry
- Short work times
- Fewer work steps
- Tiling possible after just 1 day
- Wall construction and sealing in a single work step

# Tips & tricks – Partition shower wall



## Other options

### Attachment of a glass door to the open end of the building board

A door with a total weight of up to 40 kg can be attached to the open end of the partition shower wall. Glass door: 100 cm x 200 cm and 8 mm thick, weight: 40 kg.

A reinforcement board should always be used in the region of the hinges / attachment point for the door when attaching the glass door. The wedi Tools fixings set is ideally suited for this.

The minimum tile thickness for a partition shower wall with door is 6 mm.

The fixing set should be installed as follows:

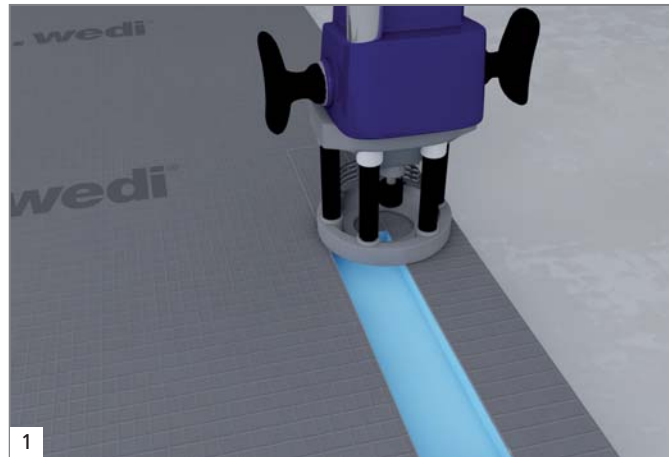

Mill out the marked area using a router. The depth depends on the thickness of the reinforcement board. 2 mm of adhesive is added.

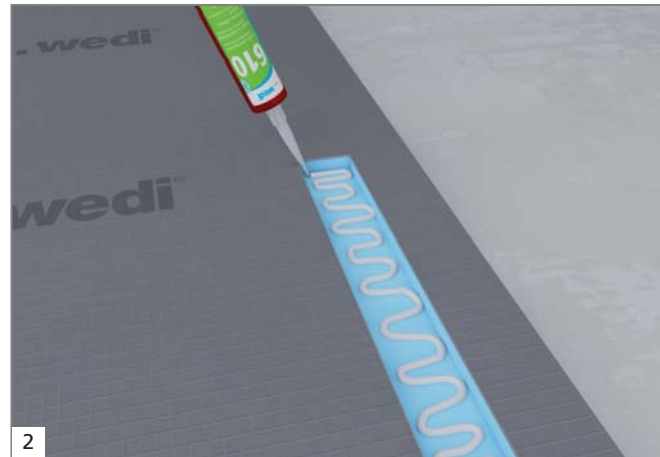

Glue the reinforcement board in, mounted flush, with wedi 610 adhesive and sealant.

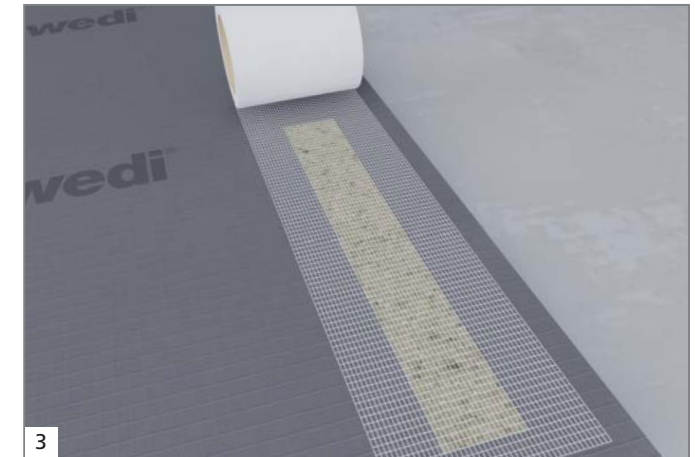

Then reinforce with wedi Tools joint reinforcement tape.

### Attachment of a radiator to the building board

In addition to the shower door, a towel heater can also be attached to the building board. Reinforcement boards should be integrated into the building board for the radiator. The wedi Tools fixings set is ideally suited for this. Installation is done as previously described.

The minimum tile thickness for a partition shower wall with radiator is 6 mm.

Each attachment point can bear a maximum load of 30 kg. The total weight of the radiator should not exceed 80 kg. Installation is done as previously described. Simply lay the pipes for the radiator in a groove in the building board and then fill with tile adhesive. Reinforce with wedi Tools joint reinforcement tape before tiling.



- Australia
- Austria
- Belgium
- Bosnia Herzegovina
- Canada
- Croatia
- Czech Republic
- Denmark
- Estonia
- Finland
- France
- Germany
- Great Britain
- Greece
- Hungary
- Iceland
- Italy
- Latvia
- Lithuania
- Luxembourg
- Netherlands
- Norway
- Poland
- Portugal
- Romania
- Russia
- Serbia
- Slovenia
- Spain
- Sweden
- Switzerland
- Turkey
- Ukraine
- USA



**wedi GmbH**

Hollefeldstraße 51  
48282 Emsdetten  
Germany

Telephone +49 2572 156-0  
Fax +49 2572 156-133

info@wedi.de  
www.wedi.eu

**wedi Systems (UK) Ltd**

Unit 4 Mercury Park · Mercury Way  
Trafford Park · M41 7LY  
Great Britain

Telephone +44 161 864 2336  
Fax +44 161 864 1323

technical@wedi.co.uk  
www.wedi.co.uk

